

LOCATION PLAN OF THE LAND OF M/S HARI INFRA BUILD PVT. LTD., ON L.R. DAG NOS.- 9, 10, 11 & 12, L.R. KHATIAN NO.- 3244, MOUZA-MASUNDA, J.L. NO.- 34, R.S. NO.- 96, HOLDING NO.- 413/J, COLLEGE PARA, WARD NO.- 07, P.S.- NEW BARRACKPORE, DIST.- NORTH 24 PARGANAS, UNDER NEW BARRACKPORE MUNICIPALITY.

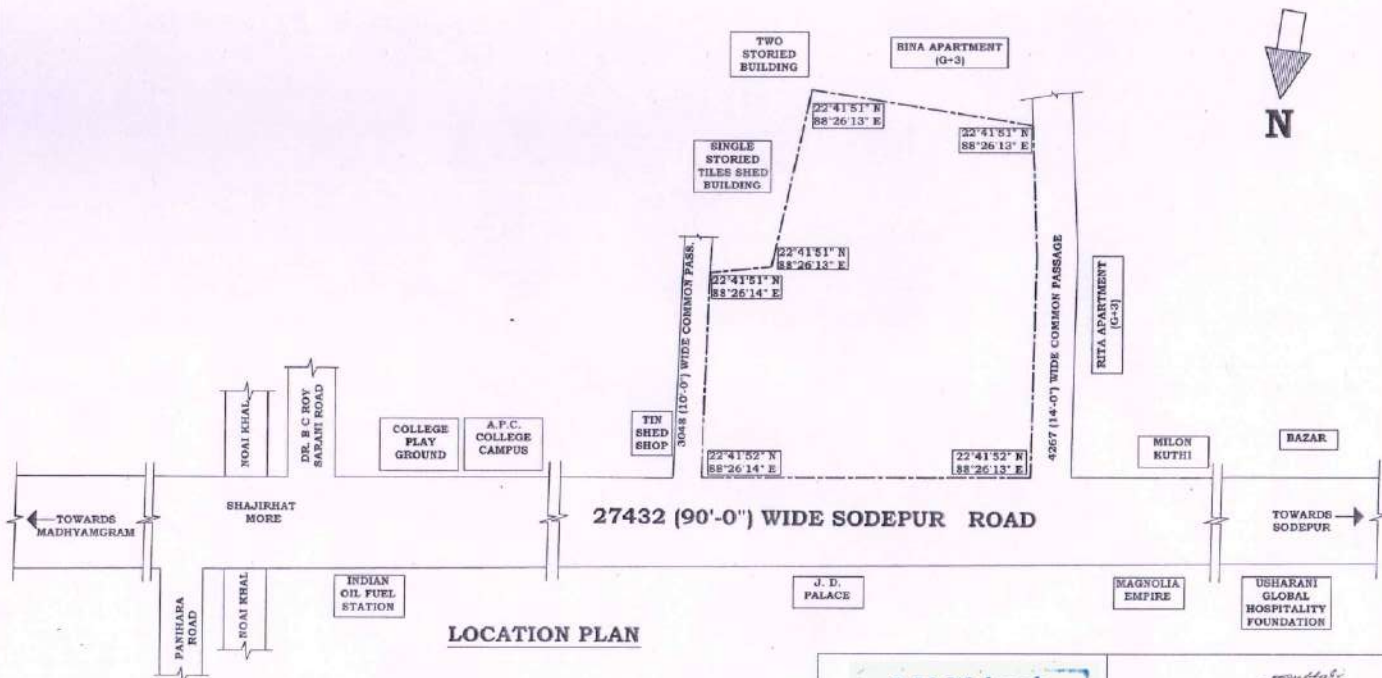

LOCATION PLAN

P M Weltech  
*Ananta Deluxo*  
 Partner

SIGNATURE OF OWNERS

ARCH VIEW  
 SARATHI KUKKOPADHYAY (D.C.E.)  
 Building Planner & Estimator  
 New Barrackpur Municipality  
 LICENCES No. 6092

SIGNATURE OF ENGINEER